

YUASA CS Packing List

Mechanical Endurance Testing System

Packing List for YUASA Jig CS

1. 1 x Instruction Manual Clamshell (CS)
2. 1 x DMX-CS Jig
3. 1 x Safety Cover

The Jig should not be assembled in the shipping box. The two Holding Beams should be attached to the Jig with two thumbscrews each to hold the Jig securely in the horizontal position. The two Holding Plates should be secured in the shipped box protected with bubble wrap. The Safety Cover should be securely placed over the Jig in the shipping box.

If you are shipping the Jig, these items may have been removed during use and they must be put back in place before shipping.

This drawing shows each of the pieces that are part of the Jig.

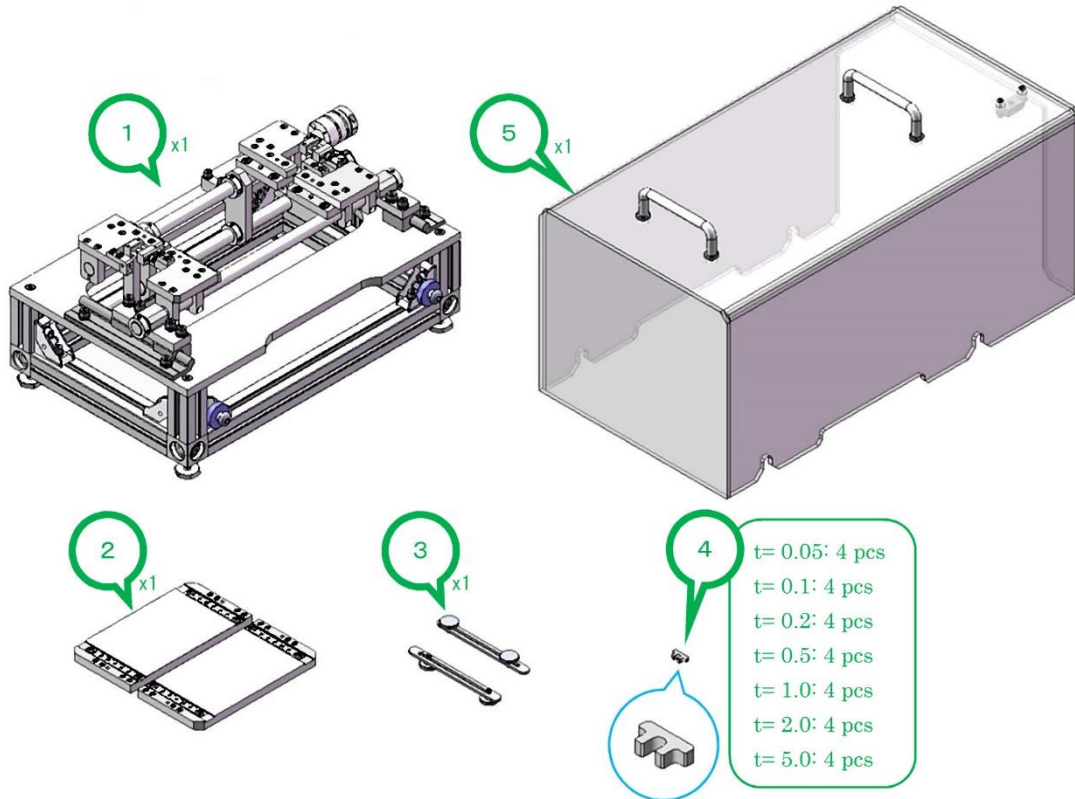

No	NAME	MANUFACTURE (MATERIAL)	NOTE
1	Basic unit	YUASA SYSTEM	
2	Holding plate	YUASA SYSTEM	For sample
3	Holding beam	YUASA SYSTEM	
4	Shim	YUASA SYSTEM	To set folding radius
5	Safety cover	YUASA SYSTEM	

NOTE The Cartridge consist of holding-plates and holding-beams.